

# SIMPLY STAINLESS

Modular Bar Solutions



**SBM-BL-6-0600**



**SBM-BL-7-0600**

SPECIFICATION	
Tops	- High quality 304 grade stainless steel. - 1.2mm gauge, no. 4 Finnish.
Core	- 3mm zincalume. - Backing. - Marine grade protective paint .
Hand Basin	- 11 litre hand basin included. - Watermark waste included.
Frames	- 30mm square stainless steel tube. - Satin polished, adjustable stainless disc feet .
Servery	- 5mm stainless steel flatbar. - Welded to frame. - 2 fixing holes.

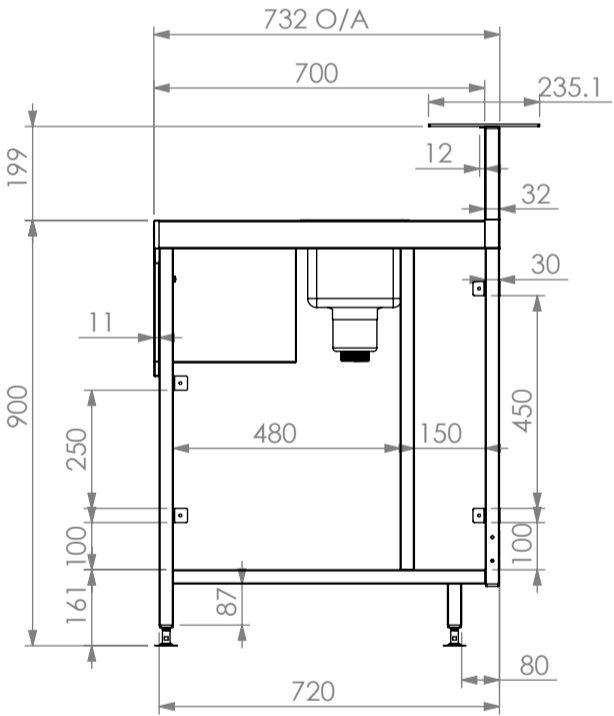

**NOTE:**  
1. 700mm DEEP MODULE ELEVATION SHOWN.

SBM-BL	BLENDER STATION			
	Product Code	Dimensions (mm)	Unit weight (Kg)	Volume (m³)
	SBM-BL-6-0600	600x600x900	30	.30
	SBM-BL-7-0600	600x700x900	32	.61



**100%  
RECYCLABLE  
STAINLESS STEEL**

