

Technical data sheet for

PW1

High Performance Potwasher

W 680mm x D 765mm x H 1850mm



The front loading PW1 washes pots, bins, trays and most bowls up to 80 litres and also has a rail for hanging whisks, ladles and other utensils.

Standard Features

- Upper and lower stainless steel arms with removable end caps for cleaning
- Auto start on door closure
- FastClean - rounded wash tank, double filtration, scrap and pump inlet filters
- Flush front design
- Large internal chamber
- Robust stainless steel construction
- Electromechanical controls
- Watermark Certified
- 2.6 litres per cycle water consumption
- 1.5kW wash pump recirculates wash water at nominal 800 litres per minute
- 5kW rinse and 2.5kW wash heating
- Triple Cycle Selection - 2, 4 and 6 minute cycles
- Powerful rinse booster elements ensure fast recovery between cycles
- 750mm high wash chamber clearance
- Counterbalanced insulated two piece door with safety stop switch
- Stainless steel support grid for bowls etc.
- Suits 500mm international racks
- Hanging rail for whisks, ladles etc

Accessories

- 1 x 500mm Dish Rack
- 1 x 500mm Cup Rack
- 1 x 8 Division Cutlery Container
- 1 x 435mm Cup Cover

Optional Accessories

- Customised loading racks for other items



WASHTECH®
PROFESSIONAL WASH SYSTEMS

The unit shall be a Washtech front loading warewasher with Watermark Certification. The unit shall have automatic fill, low level wash pump and element protection and operator selectable 2, 4 and 6 minute complete operating cycles. The usable internal wash chamber shall be 750mm high by 595mm deep by 565mm wide. The unit shall be fitted with rotating upper and lower all stainless steel wash and rinse arms all with removable end plugs for cleaning. The unit shall be fitted with a 1.5kW wash pump and hot water consumption shall be 2.6 litres per operating cycle. The unit shall require 15amp 3 phase 5 wire electrical supply. The unit shall be supplied with 500mm cup and dishracks and shipped in 100% recyclable packaging. Height of machine shown includes height with maximum 60mm adjustable leg option in use.

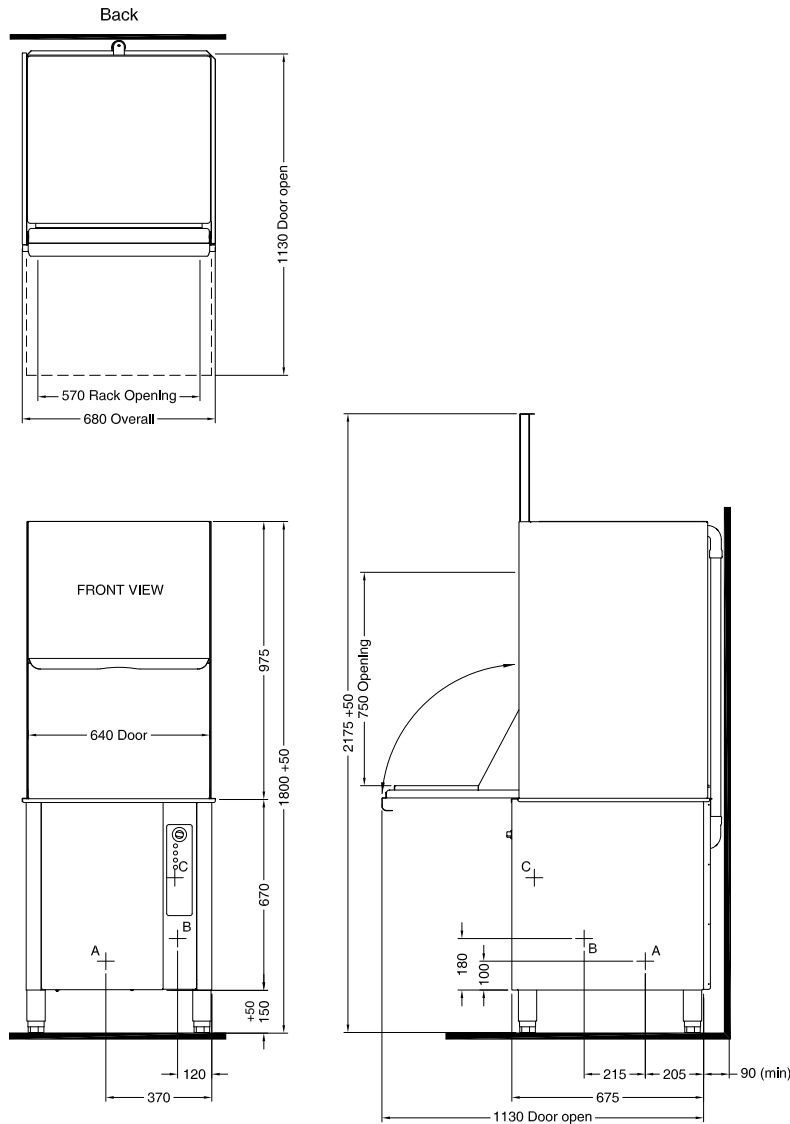

A	Hot Water	temperature connection pressure flow quality	65C 3/4" 200-350 kPa 20l/min potable & soft
B	Waste	connection line	1.5 BSP 2" BSP
C	Electrical	3 phase N+E 415V 50Hz	9kW, 15A/phase

Refer operator manual for complete installation instructions.

Dimensions

Width	680mm
Depth	765mm
Height	1850mm
Weight	125kg

Packed Dimensions

Width	850mm
Depth	850mm
Height	1790mm
Weight	165kg
Cubicmetres	1.29m³



Australia
www.moffat.com.au

New Zealand
www.moffat.co.nz

Australia
Moffat Pty Limited

Victoria/Tasmania
740 Springvale Road
Mulgrave, Victoria 3170
Telephone 03-9518 3888
Facsimile 03-9518 3833
vsales@moffat.com.au
www.moffat.com.au

New South Wales
Telephone 02-8833 4111
nswsales@moffat.com.au

South Australia
Telephone 03-9518 3888
vsales@moffat.com.au

Queensland
Telephone 07-3630 8600
qldsales@moffat.com.au

Western Australia
Telephone 08-9202 6820
bgarcia@moffat.com.au

New Zealand
Moffat Limited
Christchurch
16 Osborne Street
Christchurch 8011
Telephone +64 3-389 1007
Facsimile +64 3-389 1276
Auckland
Telephone +64 9-574 3150
export@moffat.co.nz
www.moffat.co.nz



© Copyright Moffat Ltd
Moffat /1213/511

