

**ÖZTİRYAKİLER**

Cumhuriyet Mah.Hadımköy Yolu Cad.No:8

Büyüçekmece-İstanbul-TURKEY

**e-mail:** export@oztiryakiler.com.tr**web:** www.oztiryakiler.com.tr**code:**

7919.70130.00

**SERVICE TROLLEYS****HOT BANQUET TROLLEY (5 GN 2/1-100)****model:**

OBA 70130

**MAIN FEATURES**

- \* The convection-heated banquet trolleys can be used dry or with moist air, depending on what is best for your food.
- \* Digital control with cabinet temperature display and setting. Fully compliant HACCP digital controls include visible alarms.
- \* Large storage area suitable to contain 2/1 GN containers or shelves on anti-tilt pressed runners.
- \* Optimized bottom to up forced air flow provide even temperature distribution and fast heating in any conditions.
- \* Cabinet fitted with up to 70 mm thickness of polyurethane insulation for best insulating performance with 100% environmental protection.
- \* Removable triple-chamber balloon magnetic gasket to improve insulation and reduce energy consumption.
- \* Spacers on the sides-end ensure that the convection air in the interior of the banquet trolley can circulate all around, achieving temperature distribution which is as even as possible.
- \* The slide-in convection-heated module can be removed particularly easily.
- \* The water tank for the moist-air heating can also be removed conveniently.
- \* Manual water refilling.

**CONSTRUCTION**

- \* Constructed from the highest quality AISI 304 Stainless steel.
- \* Interior base with corners, pressed from a single sheet.
- \* Easy access to the main components for maintenance.
- \* Lockable with magnetic strong handle door.
- \* High density (40-42 kg/m<sup>3</sup>) polyurethane CFC and HCFC-free insulation.
- \* Doors are self-closing and can be fully opened up to 270°
- \* Right hinged door as factory setup.

**OPTIONS**

- \* Stainless steel shelf

**ACCESSORIES****STANDARDS**

- \* EN 60335-1 European Standard relating to safety of household and similar electrical appliances
- \* EN 60335-2-49 European Standard relating to particular requirements for commercial electric hot cupboards



**ÖZTİRYAKİLER**

Cumhuriyet Mah. Hadımköy Yolu Cad.No:8

Büyükgçekmece-İstanbul-TURKEY

e-mail: export@oztiryakiler.com.tr

web: www.oztiryakiler.com.tr

**code:**

7919.70130.00

**SERVICE TROLLEYS****HOT BANQUET TROLLEY (5 GN 2/1-100)****model:**

OBA 70130

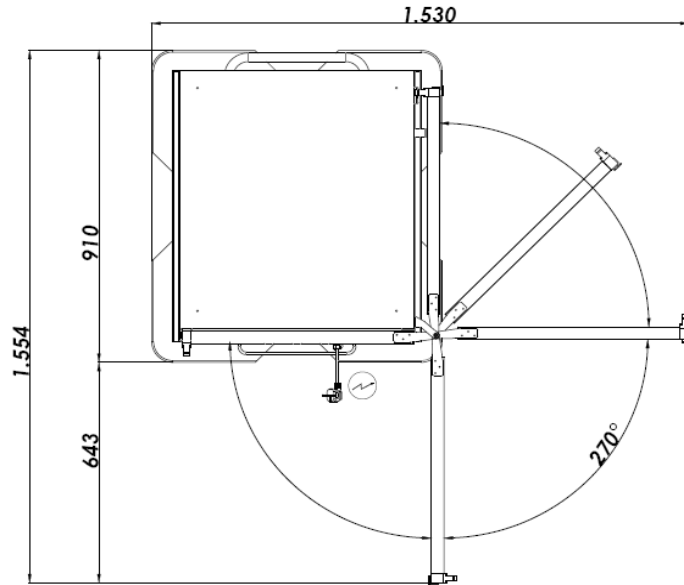
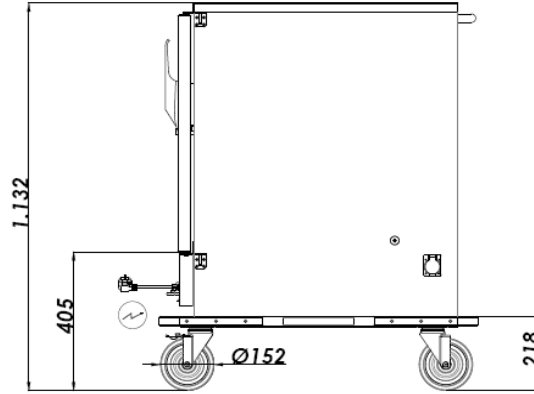
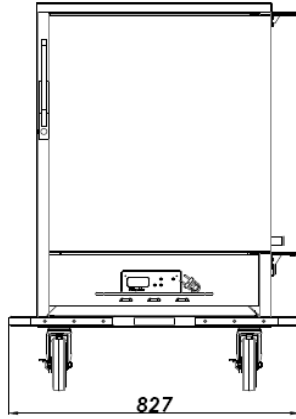
**DIMENSIONS (Net)**

* Width (mm)	827
* Depth (mm)	910
* Height (mm)	1132
* Weight (kg)	86

**DIMENSIONS (Shipping)**

* Width (mm)	
* Depth (mm)	
* Height (mm)	
* Weight (kg)	86
* Volume (m³)	1,21

**TECHNICAL SPECIFICATIONS**

* cabinet capacity	5 GN 2/1 100mm
* Regulating Temperature	70-85 °C

**ELECTRICITY**

* Power:	2	kW
* Supply Voltage:	230V / NPE	50 Hz
* Protection Class:	IP	X4

**WATER-IN**

* Cold Water Inlet:	Pressure (min-max)	bar	kPa	Temperature (min-max)	°C
* Hot Water Inlet:					
* Hardness:	F				

**DRAIN**\*  
\*