

GE

Series 6

UNDERCOUNTER GLASSWASHER



Operator Manual



WARNING

Before installation and commissioning, you must read the safety instructions and warnings carefully and all the warning labels attached to the equipment.



IMPORTANT

Failure to comply (even partially) with the instructions given in this manual will invalidate the product warranty and relieves the manufacturer of any responsibility.



IMPORTANT

The alteration of machine operation, design or the replacement of parts not approved by the manufacturer may void warranties and approvals.

We have checked that the contents of this document correspond to the model described. There may be discrepancies nevertheless, and no guarantee can be given that they are completely identical. The information contained in this document is reviewed regularly and any necessary changes will be included in the next edition. We welcome suggestions for improvement.

Document subject to change without prior notice.

Information supplied in this manual is copyright. No part of this work may be reproduced or copied in any form or by any means, electronic or mechanical without the express permission of the author / publisher.



Distributed In
Australia by

MOFFAT®

740 Springvale Road, Mulgrave 3170, Victoria, Tel 03 9518 3888 Fax 03 9518 3818

Service 1 800 622 216
Parts 1 800 337 963

Safety Instructions



WARNING

Equipment contains dangerous voltages and can be hazardous if installed or operated incorrectly. Non-compliance with **Warnings** or failure to follow the instructions contained in this manual can result in loss of life, severe personal injury or serious damage to property.

Installation

- ◆ Use qualified, skilled personnel
- ◆ Follow installation instructions
- ◆ Connect to correct voltage and supply current
- ◆ Provide fully accessible Electrical Isolation Switch & water supply valves

Training and Supervision

- ◆ Read and Understand the Operating instructions and train all staff
- ◆ This appliance must not be operated by children or infirm persons
- ◆ Machine panels must only be removed by suitably qualified and trained personnel – internal hazards include live electrics and very hot surfaces
- ◆ This appliance is not intended for use as a stepladder

Hot Surfaces

- ◆ Some surfaces may be hot or very hot

Chemicals

- ◆ Commercial dishwashing detergents are hazardous – handle with care
- ◆ Read and follow the safety information found on the labels of detergent containers and Material Safety Data Sheets
- ◆ Use protective eyewear and clothing if decanting containers

Hot Water

- ◆ Do not put hands in wash water which may be over 60°C and contain hazardous caustic detergent
- ◆ Rinse water can be over 90°C
- ◆ Door safety switches are designed for emergency use only

Cleaning

- ◆ Do not hose down the machine or splash water over the exterior
- ◆ Watch for broken glass etc when cleaning the inside of the machine

Power Cord Replacement

- ◆ If the supply cord is damaged, it must be replaced by the manufacturer or its service agent or a similar qualified person in order to avoid a hazard
-

Installation



WARNING

Installer must be suitably qualified and ensure compliance with all local codes and standards including AS/NZS 3500.1.



Failure to comply even partially with installation instructions may void the warranty.

Positioning

Unpack machine, check for damage and complete delivery. Install machine on sound waterproof self-draining floor and use adjustable feet to level machine. Adjacent surfaces should be heat resistant and moisture proof, especially benchtop lower surfaces above undercounter machines. Allow room for detergent to one side of machine or in adjacent cupboard. 20litre container requires about 450H x 250W x 350D, but smaller containers are available from many suppliers.

Water Supply

Hot water temperature	65°C ± 5°C
Connection	20 mm (3/4" BSP) male
Flow rate minimum	20 litres per minute
Hot water consumption	5 litres per cycle approximately
Cold water consumption	1.1 litres per cycle approximately
Backflow prevention	DCV = Dual Check Valves fitted standard
Pressure	200-350 KPa = 30-50 Psi.

Above this range fit pressure limiter. Don't use small diameter plastic supply lines. FLUSH supply line before connection. Poor quality supply or excessive water hardness may affect performance or damage machine – filtration and/or softening is recommended.

Waste

40 mm gravity drain – refer point B on the installation diagram – run waste directly behind the machine or through hole in base.

Power

Electrical supply required is 15A 240V 50Hz via switched outlet adjacent to machine, which is supplied with cord set including 15A plug.

Detergent

Insert detergent injector inlet hose into a container with quality glasswashing detergent. Start the machine and check the detergent flow from the container in to the machine during the wash cycle. Adjusting of dispensing rate for this unit is made by screwing in or out the central screw on the venture block.

Commissioning Procedure:

Connect all services as above. Close machine door and switch machine on, water will start filling the rinse tank. When water sprays from spray arms inside machine, switch off machine at wall. Remove lower front panel, turn on commissioning switch by breaking label over same and close panel. Machine is now ready for use.

Installation Checklist

Complete attached Installation Checklist to ensure machine is installed and running correctly, and operator is familiar with operating procedures.

Troubleshooting

If machine doesn't fill after switching on power, check and ensure that hot water supply tap is open, water supply pressure is not below specification and Dual Check Valve is correctly installed (arrows on the dual check valve's body specify water flow direction).

GE6(W) INSTALLATION DIAGRAM

GE6-W 5-09-11 1 A

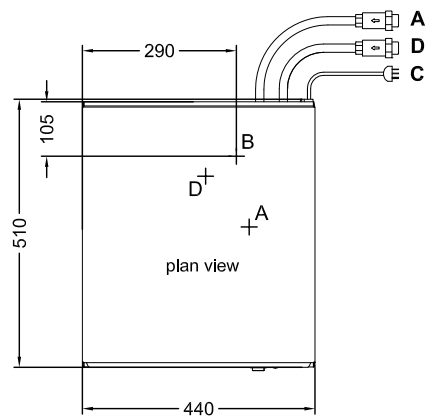
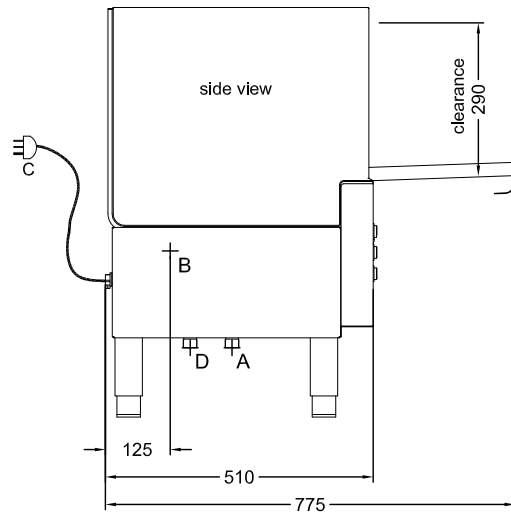
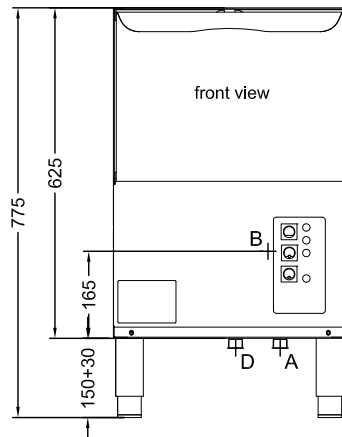

ensure dual check valves are located at water supply entry point.

- | | |
|---|-------------------|
| A | Hot water supply |
| B | Waste |
| C | Power supply |
| D | Cold water supply |

Installation Checklist

CHECK	OK / NOTES				
Delivery					
Supplied complete		no transit damage			
Position					
Level and stable		on sound, waterproof, self draining floor			
Water					
Isolator valve fitted		Accessible, all fittings sound, no leaks			
DCVs fitted (Washtech only)		Correct direction			
Temperature		65 ± 5°C			
Flow rate		Minimum 20 litres per minute			
Pressure		200-350 kpa, limiter fitted if above this range			
		Booster fitted if below this range			
Cold water when required		Pressure not above 350 kpa			
Hardness		Filter or softening if required			
Power					
Isolating switch		Fitted, functional and accessible			
Supply as specified		Voltage, current, circuit breaker			
Waste					
Usually 40 mm		Sound, no leaks			
Air gap on pumped drain		Very important GLV and UD models			
Chemicals					
	product name	container	no leaks	primed	conc.OK
Detergent					
Rinse Aid					
Machine operation					
Run several cycles					
Confirm correct operation		Including correct fill levels			
Operator training					
Confirm Operator has copy of Operator Manual and is familiar with procedures					
Start-up			Model / Serial		
Pre-rinse and racking			Owner		
Machine operation			Location		
Drain			Technician		
Clean			Date		
Shut-down			Signed		

Operation

Description of Controls

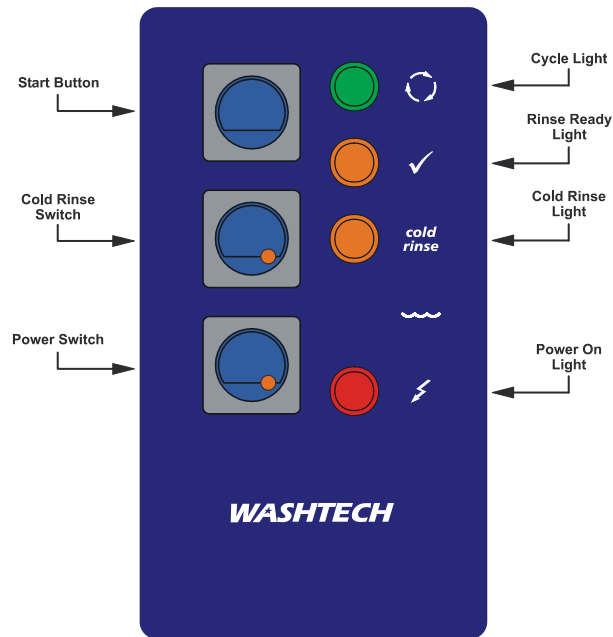

Operating Instructions

Start up

Turn wall and machine power switches on.
Power On light glows red.
Rinse Ready light (tick symbol) glows amber when the machine is up to required temperature and ready to run.

Operation

Load rack into machine and shut door.
Where applicable, turn Cold Rinse switch on for cold final rinse.
Press Start button - Cycle light glows green while machine operates.
When Cycle light goes out, cycle is complete.
Remove rack. Close door.

NOTE: Machine will not operate unless Rinse Ready light is on.

Shut down every night

Turn machine and wall power switches off.

Dishwashing Procedures

for best results

Note: these are general instructions to assist in getting the best performance from Washtech dishwashers – some comments and / or illustrations may not apply to every unit.

Installation



Read the Operator Manual. Correct installation, including an adequate supply of water at the correct temperature and pressure is essential for effective operation of your machine. Refer installation instructions for details. Drain hose outlet height is important on some models. Always install on a sound self-draining floor. Water softening is recommended in hard water areas - especially for glasswashing

Pre-rinsing



Pre-scraping of dishes is required by hygiene regulations. The best method is to pre-rinse with a pre-rinse spray unit - or alternatively by scraping or dunking in water.

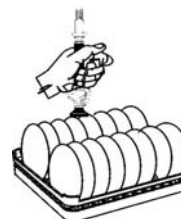

Cutlery Procedures



Pre-soak cutlery in warm water, preferably containing cutlery pre-soak compound - refer your chemical supplier.

Do not overfill cutlery containers. Cutlery should be loose with handles down. Sort after washing rather than before. Cutlery of only one type nests together and obscures wash water.

Racking Procedures

Do not overload racks, minimize the overlap of crockery. Cycle times are short and water consumption per cycle low - so there is no advantage in overloading racks.

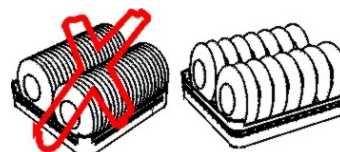

Cycle Times

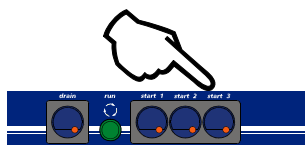

For multi-cycle machine use the longest cycle whenever possible. Note that water consumption does not increase with longer cycles. Only choose shorter, faster cycles when necessary.



Detergent

Use of correct type and quantity of low foaming detergent is essential to machine performance. Ask a professional chemical supplier to recommend the best types and concentrations of detergent, rinse fluid and cutlery soak for your situation. Note that detergents are hazardous. Poorly formulated detergents, particularly those containing chlorine, can shorten the life of dispensing systems and the machine itself.



Dishwashing Procedures

for best results

Drying



Single tank commercial dishwashers do not have a drying cycle. However, the machines do rinse at high temperatures which promote fast drying particularly when drying agents are used. We recommend prompt removal of the rack from the machine - leave the rack on the bench for 2 to 3 minutes before emptying. This time will be reduced with correct use of drying agent (rinse fluid) which reduces water surface tension and allows water to drain quickly from washware. For advice on drying agents and injectors refer to your chemical supplier.

Daily Cleaning

It is essential that the machine is drained and cleaned at the end of each day. Drain the machine then remove, clean and replace filters as per the operating instructions. Regularly check the wash and rinse jets and clean them if necessary – see below.

Regular Cleaning

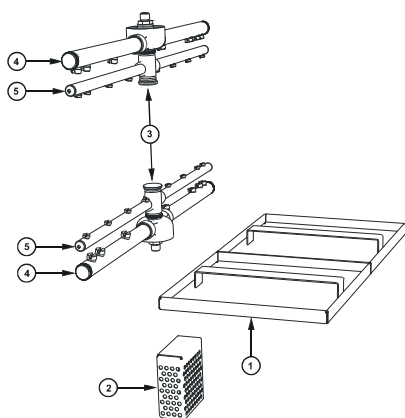

Remove scrap trays① and wash pump inlet filter②, where fitted, and rinse or brush clean.

Remove wash and rinse arms by undoing the central thumbscrews③. If necessary, remove the end cap screws④ from the wash arms and the end screws⑤ from the rinse arms and flush the arms with water and/or use a toothpick or paperclip to clear jets.

Note: arms and filters vary with model and may appear different from this illustration e.g. those models with plastic wash arms have removable jets for ease of cleaning

Regular Servicing

Regular servicing is essential for optimum performance and long machine life. Maintenance is recommended at least once every six months – especially when chemical injectors are fitted.

Please contact Moffat or your Authorised Service Provider to organize regular servicing of the dishwasher - discuss a Preventative Maintenance Agreement.



Note: these are general instructions to assist in getting the best performance from Washtech dishwashers – some comments and / or illustrations may not apply to every unit.

GE6 SCHEMATIC DIAGRAM

040130 05/09/11 1 A

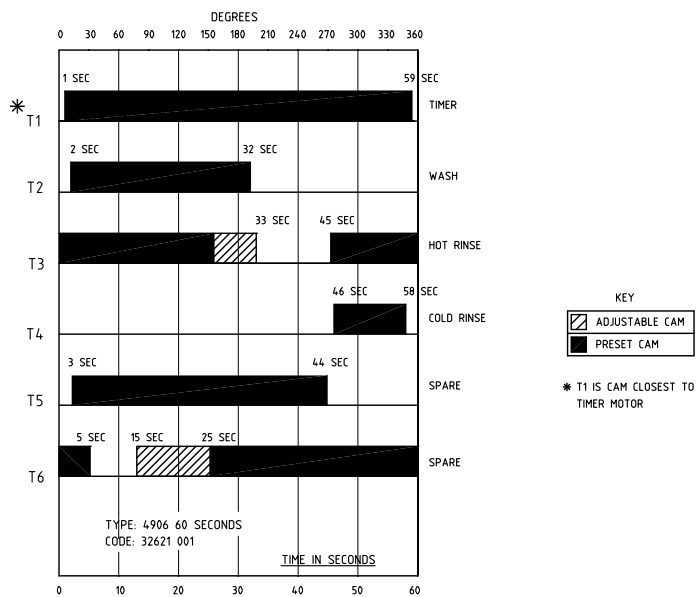
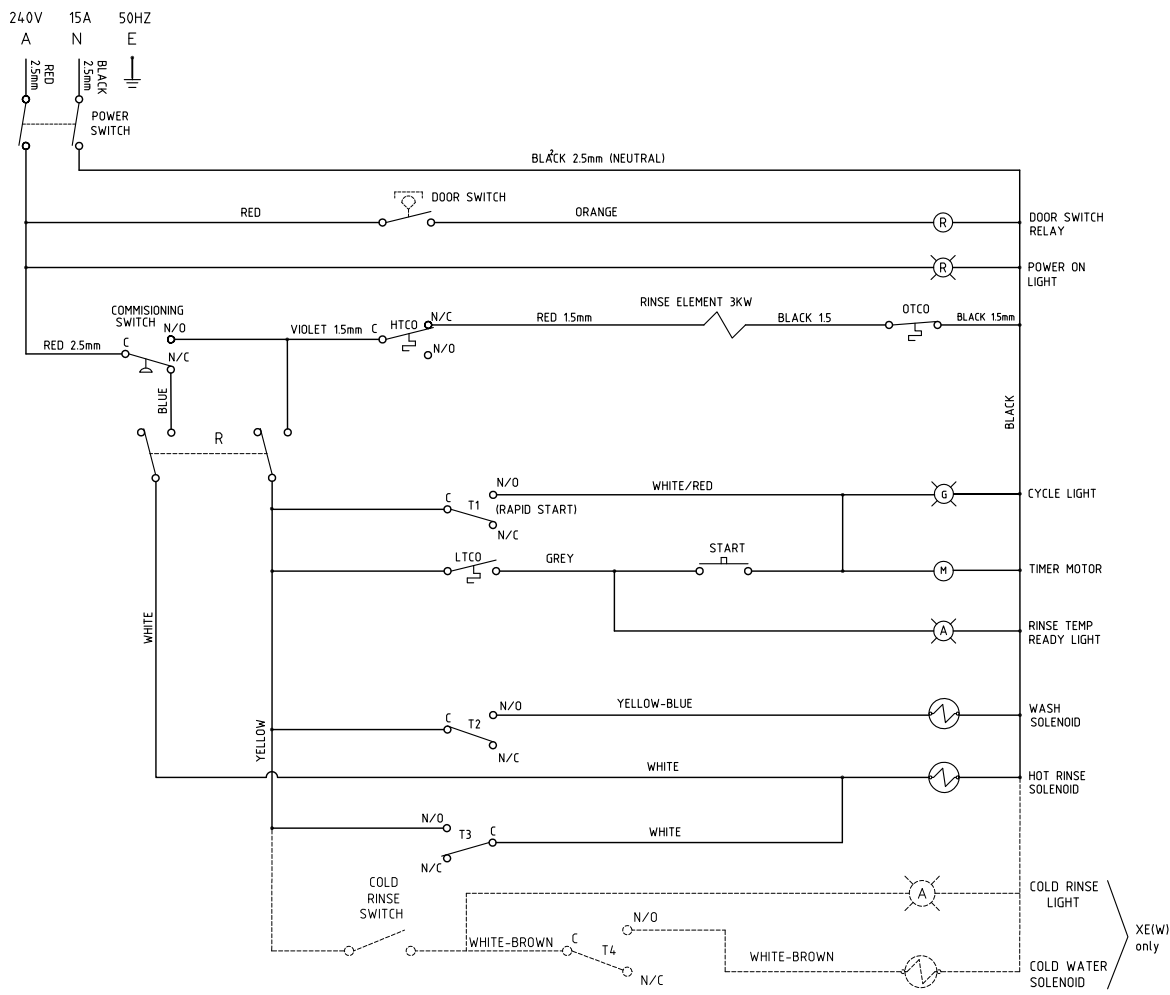

Notes
