

Project: \_\_\_\_\_ Item: \_\_\_\_\_



DLYFDN6-C12

### Standard Features:

- AISI grade stainless steel
- Heavy duty complete stainless steel cabinet frame
- 316 Stainless steel constructed tank - 2mm Thick
- In-built water overflow helps remove water impurities
- Direct basket heating elements provide precise heat dispersion
- Built-in thermal insulation layer saves energy and improves efficiency
- Temperature range: 0°C - 100°C
- 28L water capacity
- Manually operated water spindle to control integrated tank faucet
- False base provides direct burst boiling to each individual basket
- Rotary control knob to adjust desired temperature setting
- Red and green operation indicators
- Pasta baskets provided
- Tank dimensions: 490mm D x 315mm W x 165mm H (Height is measured from the base to the top of the tank)

### Options:

- SCCP - Colored Control Panel
- SCCS - Non-swivel rear castors - Set of two
- SCPK - Plinth Kit

### Specifications:

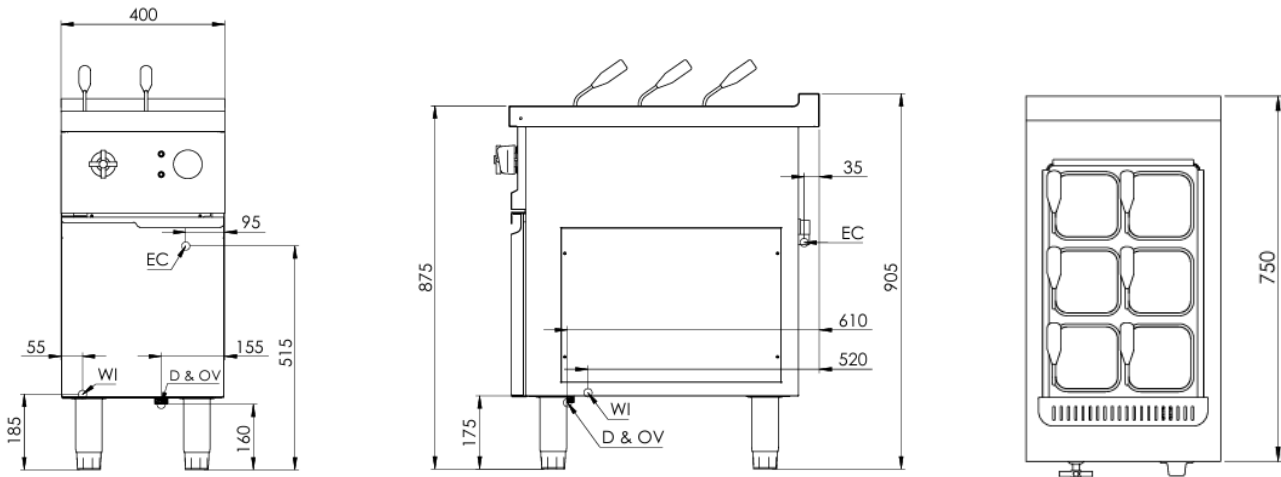

MODEL	LENGTH (mm)	DEPTH (mm)	HEIGHT (mm)	NET WEIGHT (kg)
DLYFDN6-C12	400	750	905	50

### Connections:

ELECTRICAL CONNECTION (EC)	WATER (WI) (BSP)	TANK DRAIN (D) OVERFLOW (OV)	ELECTRICAL SUPPLY REQUIREMENTS				
			VOLTAGE (V)	TYPE	FREQUENCY (Hz)	POWER (kW)	L1, L2, L3 AMPS (A)
Hard Wired	½" (M)	1" (F)	415	3P+E	50/60	12	18

- **Must** be installed by an authorised installer in accordance to **AS/NZS 3000** refer to current version

Due to ongoing Product Development, Product Improvement and Research, B+S Commercial Kitchens reserves the right to alter specifications and the design of the product without notice.

**Electromagnetic Compatibility: AS/NZS CISPR 14.1**