

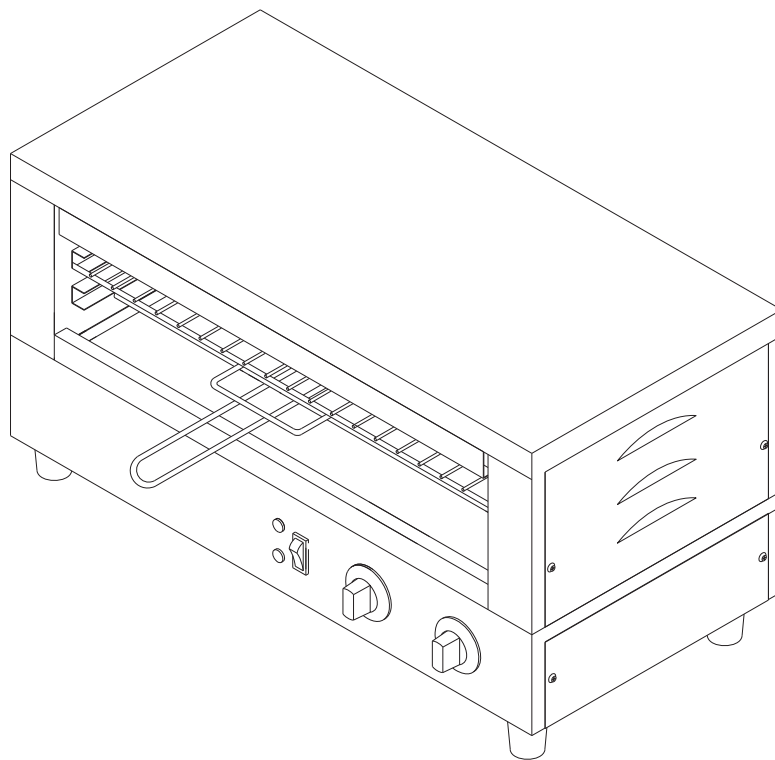

## **ELECTRIC COUNTER TOP TOASTER GRILLER**



**OPERATION MANUAL**

## **Contents**

Introduction	2
Packaging	2
Installation	2
Operation	3
Cleaning, Care and Maintenance	3
Safety	4
Trouble Shooting	5
Compliance	6
Specification	6
Electrical Diagram	7
Explosion View	8
Spare Part List	9
Contact Details	10

## **Introduction**

Congratulations on the purchase of your Birko machine. Please take time to carefully read through this manual to ensure the machine is operated and maintained properly to ensure the best, possible performance from the product for many years.

Birko will not accept liability for product failures in the event that:

- \* The instructions in this manual have not been followed correctly.
- \* Un-qualified or non-authorised personnel have tampered with the machine.
- \* Non-original spare parts are used.
- \* The machine has not been handled and cleaned correctly.
- \* There is any use damage to the unit.

## **Packaging**

Birko prides itself on quality and service, ensuring that at the time of packing, all products are supplied fully functional and free of damage.

Provided in this package are the following:

- \*Toaster Griller
- \*Crumb Tray
- \*Manual

Should you find any damage as a result of freight, please contact your Birko dealer immediately.

## **Installation**

Remove the Birko Toaster Griller from the packaging, be certain that all protective plastics and residues are thoroughly cleaned from its surface.

Locate the Birko Toaster Griller on a firm level surface.

International standards and regulations should be consulted in order to abide by standards set in relation to positioning, spacing and ventilation of the product. Oils used in these units are very dangerous. Take care when in use to avoid oil spilling on to open flames or mixing with other liquids, such as water, to avoid harmful damage.

Once the Toaster Griller has been placed in position ensure the upper and lower stainless steel trays are positioned correctly.

Supply the appropriate power and connect to mains. The toaster griller is now ready to turn on and operate. (For power supply please see technical specification sheet, page 6).

## **Operation**

The Birko Toaster Griller has upper and lower elements which can be used together or alternatively, the top element can be used on its own. This can provide flexibility when toasting and grilling.

The Toaster Griller is also fitted with a timer and an energy regulator which allows cooking continuously or by time, please see below for further details.

### **Cooking by Time**

Select the style of toasting/grilling by selecting both elements or alternatively select the upper element by pressing the element control switch. Adjust the timer dial to the desired time of cooking. When the time is selected the elements will automatically be activated at full power, when time has lapsed the elements will automatically switch off. For this cooking method ensure the energy regulator is turned to "OFF".

\*Note: If the elements are not required to turn off completely, adjust the energy regulator dial to low, this will keep the elements on after the time has lapsed. This will help to keep the product warm and will also allow for faster reheat when required.

### **Continuous Cooking**

Select the style of toasting/grilling by selecting both elements or alternatively select the upper element by pressing the element control switch.

When cooking continuously be sure the timer dial is turned to the 'OFF' position. Using the energy regulator dial select the desired temperature. When selected the elements will automatically switch on, when finished turn the energy regulator dial back to the off position. The timer will over ride the energy regulator if it is not in the 'OFF' position.

\*Summary: time control-provides full power to elements for the selected period of time.

The energy regulator control provides the desired heat control setting for continuous operation when the timer is off.

\*Note: When in operation the Toaster Griller will be hot, part of unit is the grilling rack which is handled regularly. This rack is made from steel and will hold heat, therefore gloves must be worn for protection when handling.

## **Cleaning, Care and Maintenance**

Switch off the power and disconnect from the mains.

The Toaster Griller should be cleaned after each day's operation, however, the unit may require to be cleaned more often depending on the volume of production.

Also the Toaster Griller to cool before cleaning. Remove upper and lower trays and wash them in warm soapy water, be sure to dry before returning them to the unit.

The remainder of the Toaster-Griller can be cleaned with a damp cloth using hot, soapy water.

Do not immerse completely in water or use water jets to clean.

Warm soapy water is recommended for cleaning, cleaning agents after prolonged use can damage stainless steel.

## **Safety**

Switch off power to and disconnect from the mains whilst cleaning.

Do not immerse unit in water or use water jets to clean.

If the power cord is damaged, it must be replaced by a Birko Service agent or Recommended Qualified Technician in order to avoid a hazard.

The Birko Toaster-Griller does not contain any user-serviceable parts. Birko dealers or Recommended Qualified Technicians should carry out repairs if necessary. Do not remove any components or service panels on this product.

Birko takes every care to ensure that all products are safe. Steel cutting procedures used to manufacture these items may result in sharp edges. These sharp edges are removed to the best of our ability, however we insist the operator takes care when in contact with metal edges.

Allow the Toaster-Griller to cool down after use before dismantling for cleaning, the unit will still be too hot to handle immediately after use.

This appliance is not intended for use by persons (Including Children) with reduced physical, sensory or mental capabilities, or lack of experience and knowledge, unless they have been given supervision or instruction concerning use of the appliance by a person responsible for their safety.

Children should be supervised to ensure they do not play with the appliance.

## **Trouble Shooting**

<b><u>Toaster Griller</u></b>	1002001; 1002002	
<b>Problem</b>	<b>Cause</b>	<b>Remedy</b>
The unit is not working, the indicator light is not on.	1. Mains power supply	1. Check mains power supply
	2. Unit is not switched on	2. Check that the unit is correctly plugged in and turned on; ensure you have read the manual for both methods of operation: ➤ <b>Timer Control:</b> provides full power to the elements for the period of time selected ➤ <b>Dial Control:</b> provides desired heat for continued operation when the timer is off
	3. Dial Control or Timer are faulty	3. Call service agent or qualified technician
	4. Plug and lead are damaged	4. Call service agent or qualified technician
	5. Internal wiring fault	5. Call service agent or qualified technician
The unit is heating but the indicator lights are not on	1. The indicator light is faulty	1. Call service agent or qualified technician
Slow heat up or no heat up, power is on	1. Incorrect operation	1. Ensure that you have clearly read the manual, fully taking into account whether the unit has been selected for Timer Control or for Dial Control and also whether single or double element heating has been selected
	2. Elements are faulty	2. Call service agent or qualified technician
	3. Power dial is faulty	3. Call service agent or qualified technician

## **Compliance**

Birko products have undergone strict product testing in order to comply with regulatory standards and specifications set by international independent, commonwealth and federal authorities.

As testimony to such compliance Birko products carry the following marks/symbols:



## **Specifications**

MODEL	VOLTAGE	POWER	DIMENSIONS (MM)			ELEMENT
			WIDTH	DEPTH	HEIGHT	
1002001	220-240V	2200W	600	290	315	QUARTZ
1002002	~ 50HZ	3200W	600	290	315	QUARTZ

## **Electrical Diagram**

MODEL: 1002001

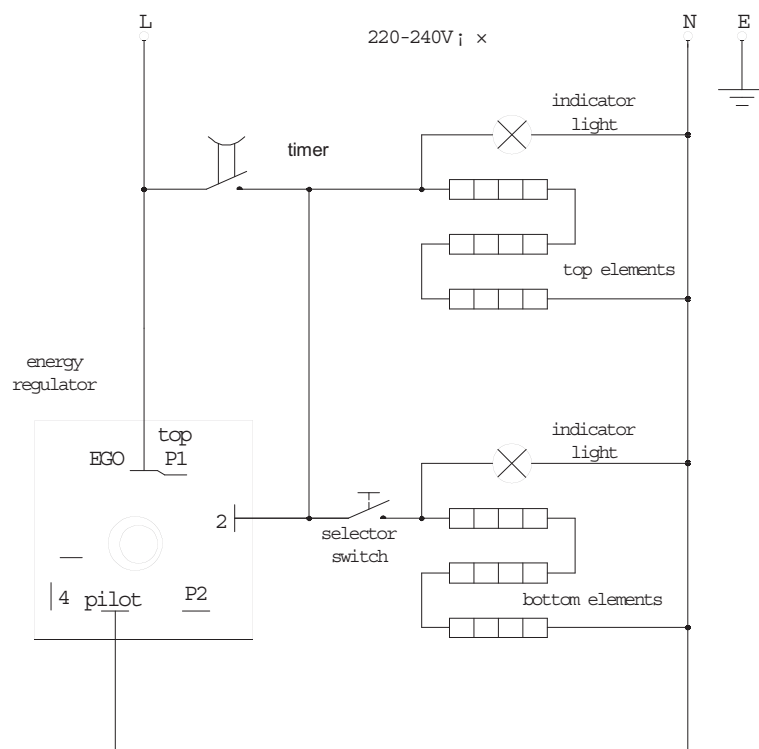

MODEL: 1002002

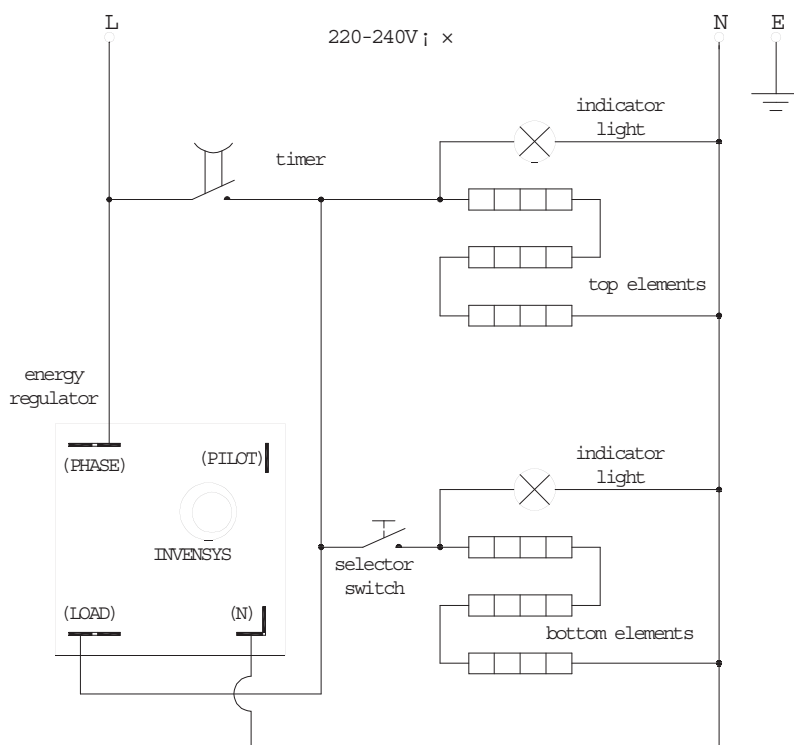

The above circuit diagram has been provided to assist qualified technicians, Only Birko Foodservice agents or Recommended Qualified Technicians should carry out repairs if needed. Do not remove any components or service panels on this product.



**Explosion View**

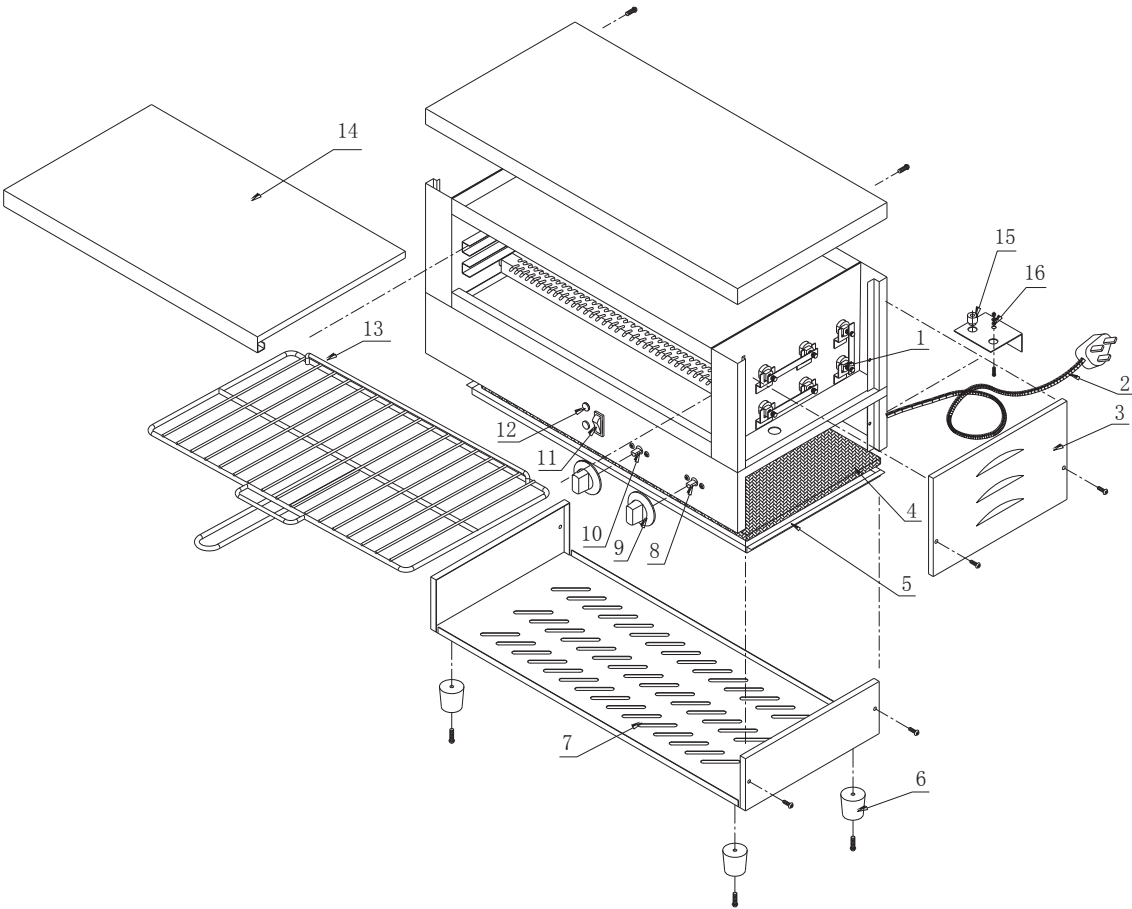

**Spare Parts List**

NO	DESCRIPTION	QTY	CODE
1	QUARTZ ELEMENT 1002001 1002002	6 6	1315180 1315181
2	LEAD + PLUG 1002001 1002002	1	1315011 1315008
3	SIDE PANEL	2	
4	INSULATION	1	
5	INSULATION FIXING PLATE	1	
6	FEET	4	1315009
7	BASE PLATE	1	
8	ENERGY REGULATOR 1002001 1002002	1	1315185
9	DIAL	2	1315184
10	TIMER	1	1315186
11	ON/OFF SWITCH	1	1315187
12	INDICATER LIGHT	2	1315188
13	GRILLING RACK	1	1315005
14	CRUMB TRAY	2	1315189
15	CERAMIC TUBE	2	
16	EARTH CONNECTING NUT	2	

## **Contact Details**

Birko Heaters Australia Pty Ltd., ABN 39 103 881 625  
67 Allingham St  
Condell Park  
N.S.W. 2200  
AUSTRALIA  
Local Ph: 1300 724 955  
Local Fax: 1300 735 259  
sales@birkoheaters.com  
[www.birkoheaters.com](http://www.birkoheaters.com)

Zenith Heaters Limited,  
IRD No. 95 640 729  
Unit 2/15 Moselle Avenue,  
Henderson.  
Auckland. 0610  
NEW ZEALAND.  
Telephone: 0800 558055  
Facsimile: 0800 559055  
[www.zenithheaters.co.nz](http://www.zenithheaters.co.nz)

The term 'Birko' is a registered trade mark of Birko Heaters Australia Pty. Ltd.

Please keep this manual in a safe place for future use!

