

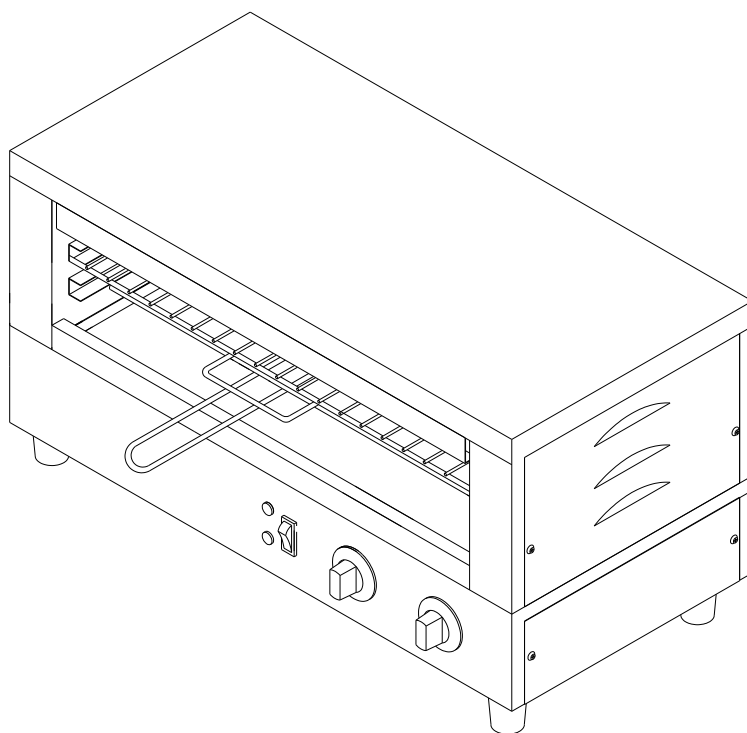

ELECTRIC COUNTER TOP TOASTER GRILLER



OPERATION MANUAL

Contents

Introduction	2
Packaging	2
Installation	2
Operation	3
Cleaning, Care and Maintenance	3
Safety	4
Trouble Shooting	5
Compliance	6
Specification	6
Electrical Diagram	7
Explosion View	8
Spare Part List	9
Warranty Information	10

Introduction

Congratulations on the purchase of your Birko machine. Please take time to carefully read through this manual to ensure the machine is operated and maintained properly to ensure the best, possible performance from the product for many years.

Birko will not accept liability for product failures in the event that:

- * The instructions in this manual have not been followed correctly.
- * Un-qualified or non-authorised personnel have tampered with the machine.
- * Non-original spare parts are used.
- * The machine has not been handled and cleaned correctly.
- * There is any use damage to the unit.

Packaging

Birko prides itself on quality and service, ensuring that at the time of packing, all products are supplied fully functional and free of damage.

Provided in this package are the following:

- *Toaster Griller
- *Crumb Tray
- *Manual

Should you find any damage as a result of freight, please contact your Birko dealer immediately.

Installation

Remove the Birko Toaster Griller from the packaging, be certain that all protective plastics and residues are thoroughly cleaned from its surface.

Locate the Birko Toaster Griller on a firm level surface.

International standards and regulations should be consulted in order to abide by standards set in relation to positioning, spacing and ventilation of the product. Oils used in these units are very dangerous. Take care when in use to avoid oil spilling on to open flames or mixing with other liquids, such as water, to avoid harmful damage.

Once the Toaster Griller has been placed in position ensure the upper and lower stainless steel trays are positioned correctly.

Supply the appropriate power and connect to mains. The toaster griller is now ready to turn on and operate. (For power supply please see technical specification sheet, page 6).

Operation

The Birko Toaster Griller has upper and lower elements which can be used together or alternatively, the top element can be used on its own. This can provide flexibility when toasting and grilling.

The Toaster Griller is also fitted with a timer and an energy regulator which allows cooking continuously or by time, please see below for further details.

Cooking by Time

Select the style of toasting/grilling by selecting both elements or alternatively select the upper element by pressing the element control switch. Adjust the timer dial to the desired time of cooking. When the time is selected the elements will automatically be activated at full power, when time has lapsed the elements will automatically switch off. For this cooking method ensure the energy regulator is turned to "OFF".

*Note: If the elements are not required to turn off completely, adjust the energy regulator dial to low, this will keep the elements on after the time has lapsed. This will help to keep the product warm and will also allow for faster reheat when required.

Continuous Cooking

Select the style of toasting/grilling by selecting both elements or alternatively select the upper element by pressing the element control switch.

When cooking continuously be sure the timer dial is turned to the 'OFF' position. Using the energy regulator dial select the desired temperature. When selected the elements will automatically switch on, when finished turn the energy regulator dial back to the off position. The timer will over ride the energy regulator if it is not in the 'OFF' position.

*Summary: time control-provides full power to elements for the selected period of time.

The energy regulator control provides the desired heat control setting for continuous operation when the timer is off.

*Note: When in operation the Toaster Griller will be hot, part of unit is the grilling rack which is handled regularly. This rack is made from steel and will hold heat, therefore gloves must be worn for protection when handling.

Cleaning, Care and Maintenance

Switch off the power and disconnect from the mains.

The Toaster Griller should be cleaned after each day's operation, however, the unit may require to be cleaned more often depending on the volume of production.

Also the Toaster Griller to cool before cleaning. Remove upper and lower trays and wash them in warm soapy water, be sure to dry before returning them to the unit.

The remainder of the Toaster-Griller can be cleaned with a damp cloth using hot, soapy water.

Do not immerse completely in water or use water jets to clean.

Warm soapy water is recommended for cleaning, cleaning agents after prolonged use can damage stainless steel.

Safety

Switch off power to and disconnect from the mains whilst cleaning.

Do not immerse unit in water or use water jets to clean.

If the power cord is damaged, it must be replaced by a Birko Service agent or Recommended Qualified Technician in order to avoid a hazard.

The Birko Toaster-Griller does not contain any user-serviceable parts. Birko dealers or Recommended Qualified Technicians should carry out repairs if necessary. Do not remove any components or service panels on this product.

Birko takes every care to ensure that all products are safe. Steel cutting procedures used to manufacture these items may result in sharp edges. These sharp edges are removed to the best of our ability, however we insist the operator takes care when in contact with metal edges.

Allow the Toaster-Griller to cool down after use before dismantling for cleaning, the unit will still be too hot to handle immediately after use.

Children and infirm persons should not operate these appliances unless adequately supervised.

Trouble Shooting

<u>Toaster Griller</u>	1002001; 1002002	
Problem	Cause	Remedy
The unit is not working, the indicator light is not on.	1. Mains power supply	1. Check mains power supply
	2. Unit is not switched on	2. Check that the unit is correctly plugged in and turned on; ensure you have read the manual for both methods of operation: ➤ Timer Control: provides full power to the elements for the period of time selected ➤ Dial Control: provides desired heat for continued operation when the timer is off
	3. Dial Control or Timer are faulty	3. Call service agent or qualified technician
	4. Plug and lead are damaged	4. Call service agent or qualified technician
	5. Internal wiring fault	5. Call service agent or qualified technician
The unit is heating but the indicator lights are not on	1. The indicator light is faulty	1. Call service agent or qualified technician
Slow heat up or no heat up, power is on	1. Incorrect operation	1. Ensure that you have clearly read the manual, fully taking into account whether the unit has been selected for Timer Control or for Dial Control and also whether single or double element heating has been selected
	2. Elements are faulty	2. Call service agent or qualified technician
	3. Power dial is faulty	3. Call service agent or qualified technician

Compliance

Birko products have undergone strict product testing in order to comply with regulatory standards and specifications set by international independent, commonwealth and federal authorities.

As testimony to such compliance Birko products carry the following marks/symbols:

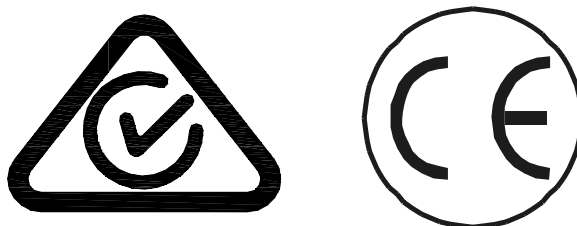

Specifications

MODEL	VOLTAGE	POWER	DIMENSIONS(MM)			ELEMENT
			WIDTH	DEPTH	HEIGHT	
1002001	220-240V ~ 50Hz	2200W	600	290	315	QUARTZ
1002002		3200W	600	290	315	QUARTZ

Electrical Diagram

MODEL: 1002001

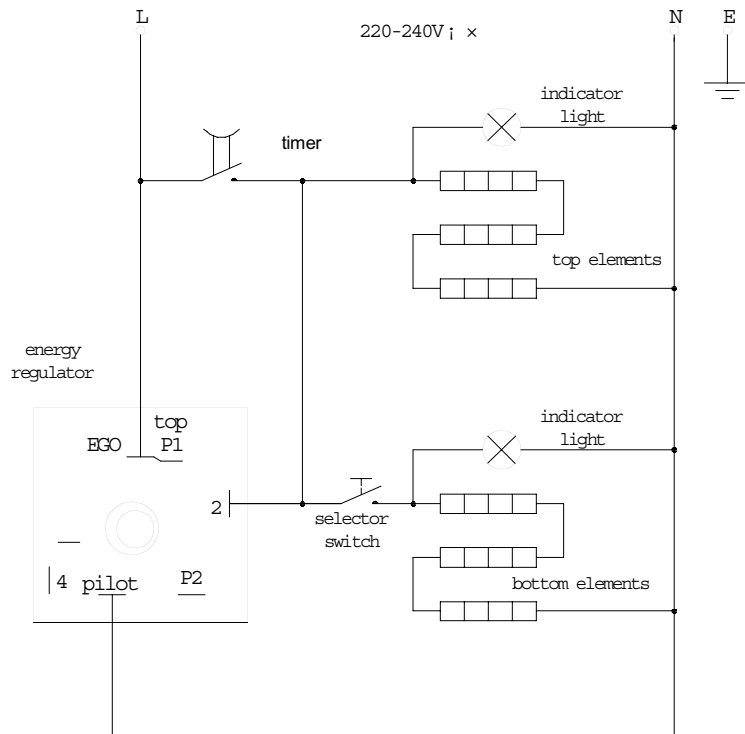

MODEL: 1002002

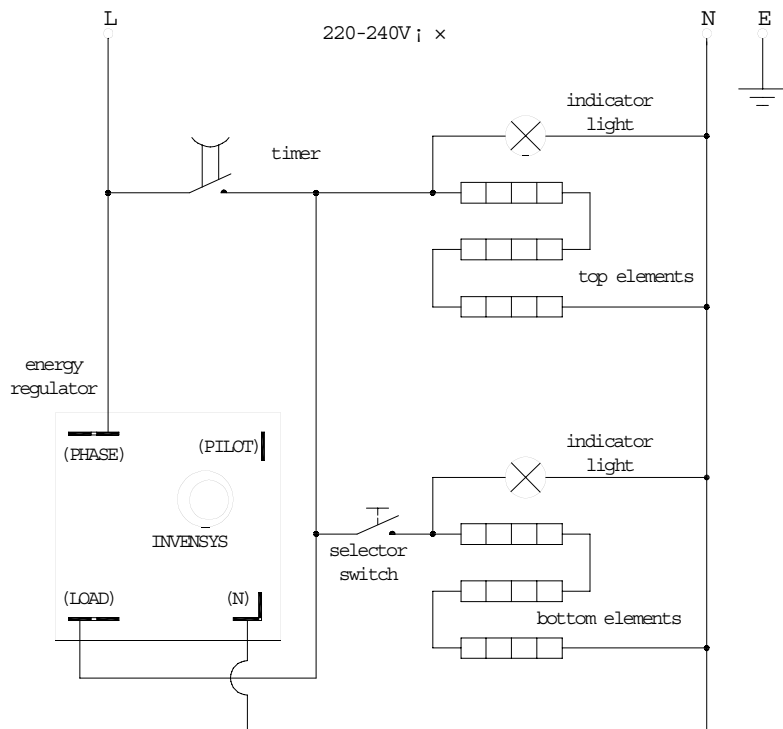

The above circuit diagram has been provided to assist qualified technicians, Only Birko Foodservice agents or Recommended Qualified Technicians should carry out repairs if needed. Do not remove any components or service panels on this product.

Explosion View

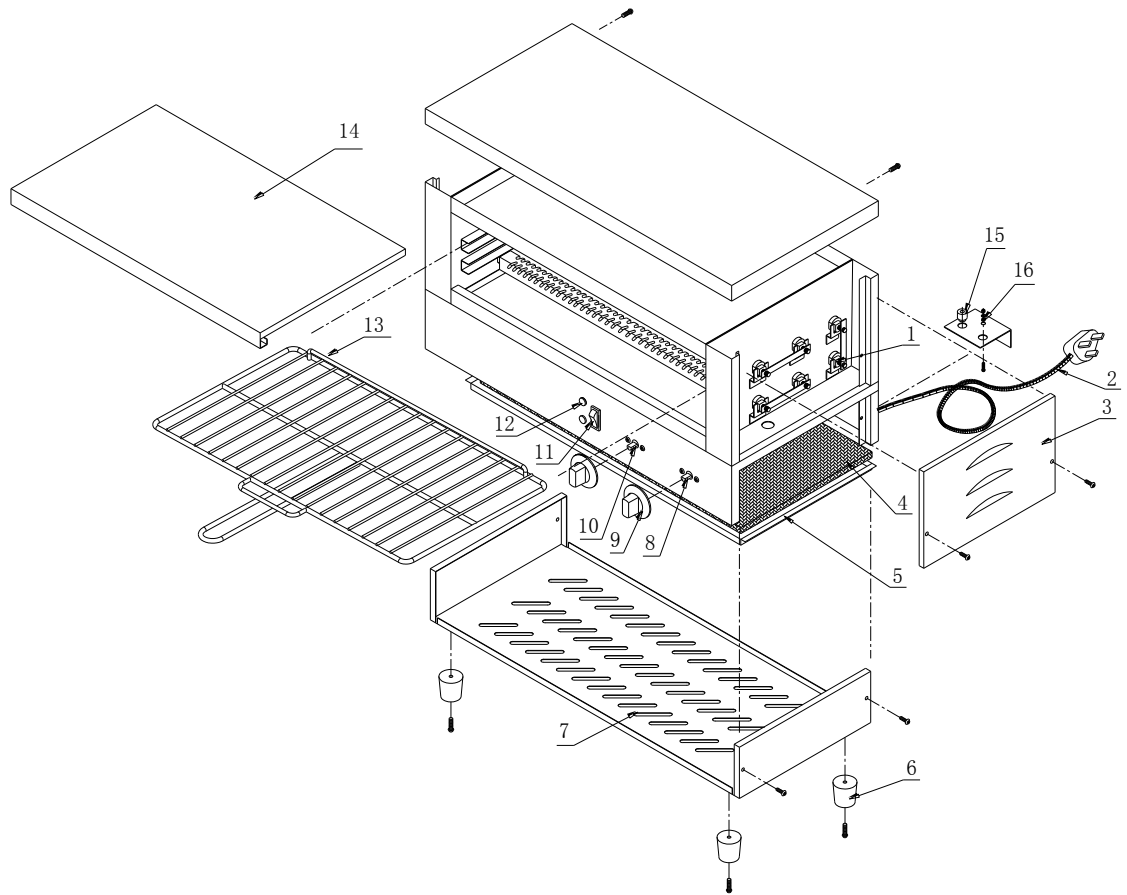

Spare Parts List

NO	DESCRIPTION	QTY	CODE
1	QUARTZ ELEMENT 1002001 1002002	6 6	1315180 1315181
2	LEAD + PLUG 1002001 1002002	1	1315011 1315008
3	SIDE PANEL	2	
4	INSULATION	1	
5	INSULATION FIXING PLATE	1	
6	FEET	4	1315009
7	BASE PLATE	1	
8	ENERGY REGULATOR 1002001 1002002	1	1315185 1315184
9	DIAL	2	1315186
10	TIMER	1	1315187
11	ON/OFF SWITCH	1	1315188
12	INDICATER LIGHT	2	1315005
13	GRILLING RACK	1	1315189
14	CRUMB TRAY	2	
15	CERAMIC TUBE	2	
16	EARTH CONNECTING NUT	2	

Warranty Information

Certain warranties may be implied by law into your contract with Birko. The warranty provided below is additional to these implied warranties and nothing set out below shall limit your statutory rights or rights at law. Birko Heaters (Aust) Pty Ltd warrants that, should any part fail within 12 calendar months of purchase, that part will be repaired or replaced free of charge by Birko or its Distributor or Service Provider, except as set out below, provided the appliance is installed and used strictly in accordance with the instructions supplied, and that failure is not due to accident, misuse, abuse, unsuitable water conditions, or to any alteration, modification or repair by any party not expressly nominated by Birko. No costs are payable by the customer other than any mileage or travelling-time charges incurred by an authorised Birko Service agent, when travel is in excess of 25 kms from their depot, or the cost of removal, cartage and re-installation of any component of the appliance if it needs to be returned for repair to Birko or its Distributor. This warranty does not cover damage resulting from non-operation of the appliance, the use of non authorised parts or consequential damage to any other goods, furnishings or property. No warranty applies to the life of any filtration cartridge installed with the appliance, as cartridge life may vary according to water quality and the rate of water consumption. Birko does not exclude, restrict or modify any liability that cannot be excluded, restricted or modified or which cannot, except to a limited extent, be excluded, restricted or modified as between the owner or user and Birko under the laws applicable. Furthermore, this warranty does not displace any statutory warranty, but, to the extent to which Birko is entitled to do so, the liability of Birko under any statutory warranty will be limited at Birko's option to the replacement of the appliance or supply of equivalent appliance, the payment of the cost of replacing the appliance or acquiring an equivalent appliance, or the payment of the cost of having the appliance repaired or the repair of the appliance.

Registering Your Purchase

Registering your purchase on the Birko website may help to establish date of purchase should it become necessary to service the appliance under terms of the Birko warranty. To register your installation go to www.birkoheaters.com and click on "Register your purchase".

Birko Heaters Australia Pty Ltd., ABN 39 103 881 625
67 Allingham St
Condell Park
N.S.W. 2200
AUSTRALIA
Local Ph: 1300 724 955
Local Fax: 1300 735 259
sales@birkoheaters.com
www.birkoheaters.com

Zenith Heaters Limited,
IRD No. 95 640 729
Unit 2/15 Moselle Avenue,
Henderson.
Auckland. 0610
NEW ZEALAND.
Telephone: 0800 558055
Facsimile: 0800 559055
www.zenithheaters.co.nz

The term 'Birko' is a registered trade mark of Birko Heaters Australia Pty. Ltd.

Please keep this manual in a safe place for future use!

